

LED NEON FLEX SPECIFICATION

IP67 NEON 1010 24V SIDE VIEW

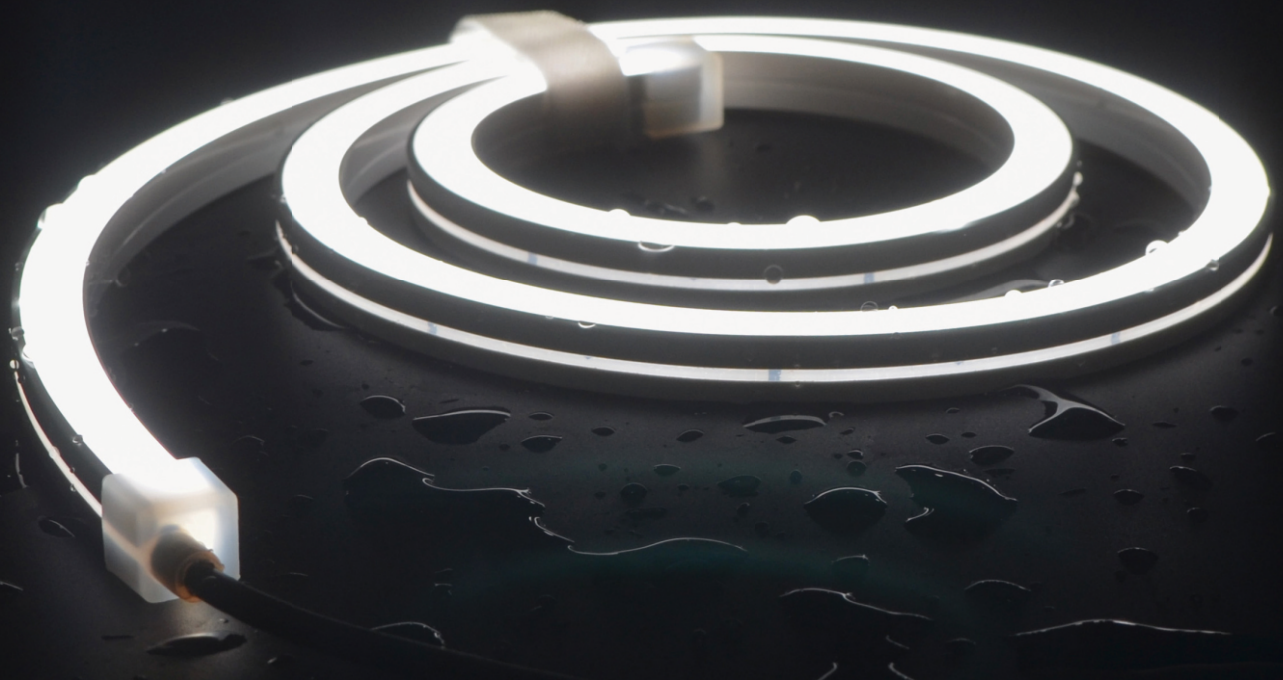

IP67 NEON 1010 24V SIDE VIEW

Regular power 5W/m and 10W/m for option

Max length 5 meters with one end power

Eight CCT optional from 2100K to 6000K

2100K
2400K
2700K
3000K
3500K
4000K
5000K
6000K

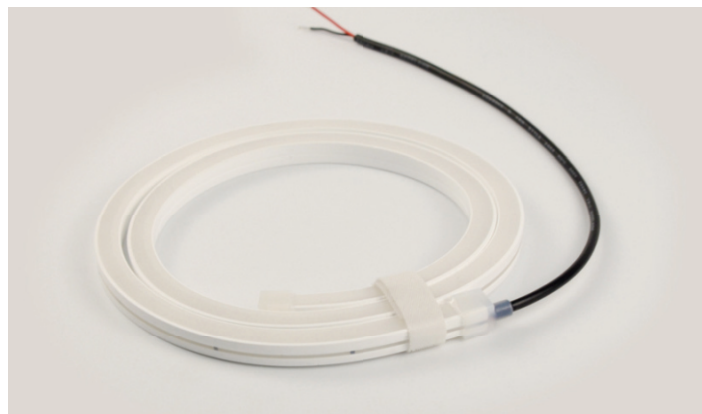

Dimensions & Waterproof

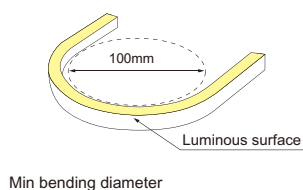
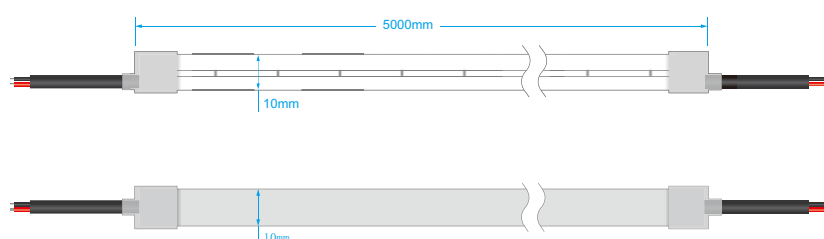

Min bending diameter

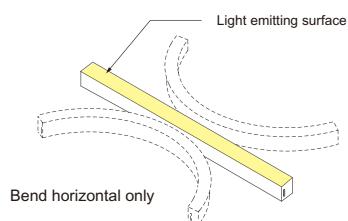

Bend horizontal only

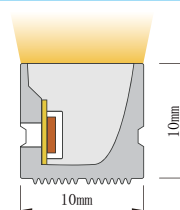

Across section size's picture

Electrical Parameter

Voltage	DC24V
LED PIN Temperature	Max. 65°C
Storage Temperature	-25°C ~ 60°C
Ambient Temperature	Min. -25°C Max (Table below)
CRI	>90

Specification

Power	5 w/m	10 w/m
Efficacy@4000K	68 lm/w	66.1 lm/w
Max Ambient Temperature	55°C	45°C

Due to the tolerance of the production and electrical components, output value and electrical power can vary up to 10%

Single color parameters

Part Number	CCT (K)	Unit cut (mm)	CV/CC	Low power(5w/m)		High power(10w/m)	
				(lm/m)	(max length)	(lm/m)	(max length)
▶ LCE-S1010-W21	2000-2200K	35.7	CV	279	5m	533	5m
▶ LCE-S1010-W24	2300-2500K	35.7	CV	292	5m	564	5m
▶ LCE-S1010-W27	2600-2800K	35.7	CV	298	5m	571	5m
▶ LCE-S1010-W30	2900-3100K	35.7	CV	322	5m	623	5m
▶ LCE-S1010-W35	3400-3700K	35.7	CV	306	5m	593	5m
▶ LCE-S1010-W40	3800-4300K	35.7	CV	340	5m	660	5m
▶ LCE-S1010-W50	4800-5300K	35.7	CV	346	5m	677	5m
▶ LCE-S1010-W60	5900-6400K	35.7	CV	356	5m	690	5m
▶ LCE-S1010-R	Red(620-625nm)	35.7	CV	140	5m	275	5m
▶ LCE-S1010-G	Green(515-525nm)	35.7	CV	276	5m	540	5m
▶ LCE-S1010-B	Blue(460-465nm)	35.7	CV	71	5m	131	5m
▶ LCE-S1010-Y	Yellow(585-595nm)	35.7	CV	127	5m	246	5m
▶ LCE-S1010-P	Pink	35.7	CV	232	5m	452	5m

Note: CC stands for constant current, CV stands for constant voltage, max length of CV is 5m.

Cautions

The unused product and unused product after unpacking should be sealed with the packaging bag to avoid prolonged exposure.

Tests showed that nail and benzene substances will have yellowing effects on silicone gel; in the new indoor decoration environment, epoxy floor paint, wall paint, wallpaper adhesive, various decoration materials or new furniture, possibly release of nail and benzene substances, it is recommended to remove formaldehyde and benzene or ventilate for a period of time in the new indoor decoration environment, and then install the neon strip to avoid yellowing of the silicone gel.

Cutting method



Remark: The bottom of the led strip has transparent window, the black marker is the cutting position

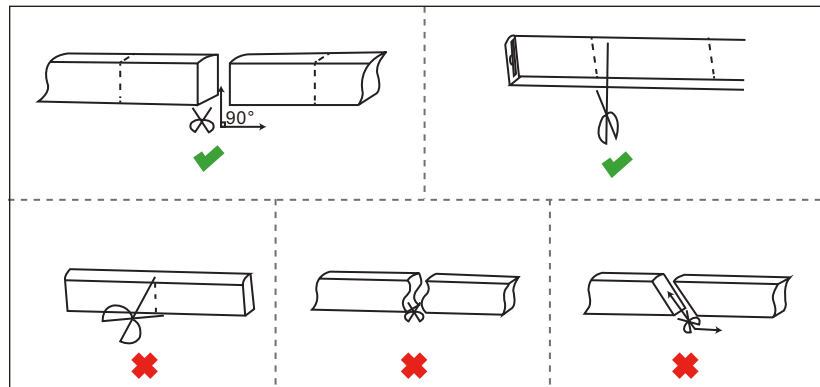

Mounting Accessory

Stainless Steel Mounting clips

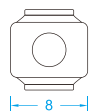
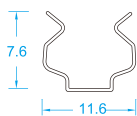

Aluminium Profile

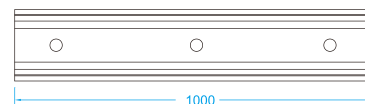
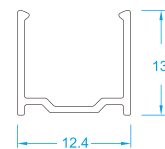

Installation

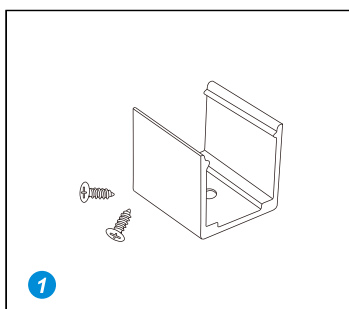

1 Prepare the screws and mounting clips

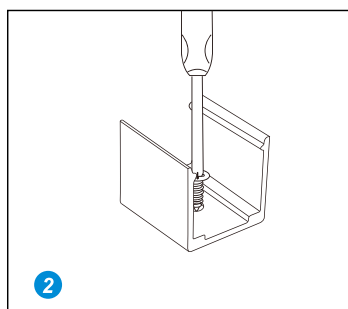

2 Adjust the fixed clips to the appropriate place, use a screwdriver to fix the screw.

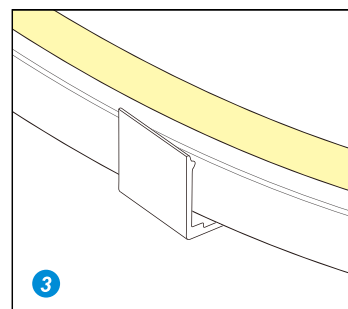

3 Put the light emitting surface upwards, then insert the LED strip into the fixed clips.

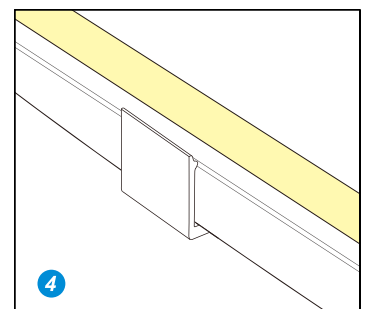

4 Fix NEON strip completely into the fixed clip.